

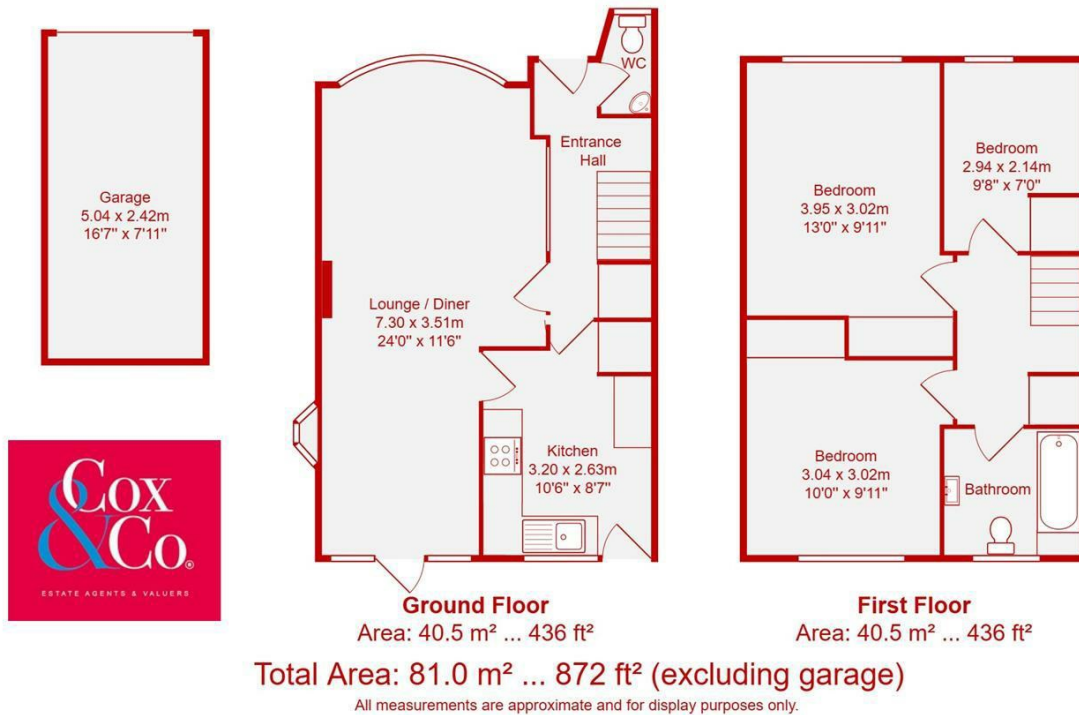

- End Of Terraced House
- No Onward Chain
- Rear Garden With Side Access
- Very Popular Location
- Three Bedrooms
- Garage In Separate Compound
- Close To Worthing Seafront
- Potential To Improve & Extend (stp)

## Hythe Road, Worthing

Price: £375,000 Freehold



A well-positioned home located on Hythe Road, a desirable residential street in Worthing, is ideally situated just moments from the seafront. The property enjoys easy access to Worthing's attractive coastline and promenade, perfect for walks, leisure and outdoor living.

The location is particularly convenient, with a range of local shops, cafés and everyday amenities close by, while Worthing town centre offers a wider selection of retail, restaurants and leisure facilities within easy reach.

Families are well served by a number of highly regarded local schools, including Elm Grove Primary School and Worthing High School, both within a short distance of each other, making this an excellent choice for those with children.

For commuters, the property benefits from excellent transport links, with nearby bus routes including the 700 Coastliner providing direct access along the south coast, as well as convenient connections to Brighton and surrounding areas. West Worthing railway station is also within easy reach, offering regular services to London and beyond.

Overall, this is a superbly located home that combines coastal living with everyday convenience, making it ideal for families, professionals, and those seeking a well-connected seaside lifestyle.

